



Naziv: CBU18S2B

Eno-področna servirna vinska vitrina

Podpultno vgradna



- + Kapaciteta: 18 steklenic*
- + Podpultno vgradna
- + Dizajn: črno ohišje & črn okvir vrat & črni ročaj
- + Hlajenje: kompresor
- + Vrsta hlajenja: zračno gibljiv sistem
- + Nastavljivo temperaturno območje uporabe: 5-20°C
- + Elektronsko upravljanje
- + Termometer z modro osvetlitvijo
- + Bele LED luči z možnostjo izklopa
- + 1 **zamenljiva** steklena vrata z Uv zaščita, 2-slojna steklitev, kajeno steklo (rjavo barvano)

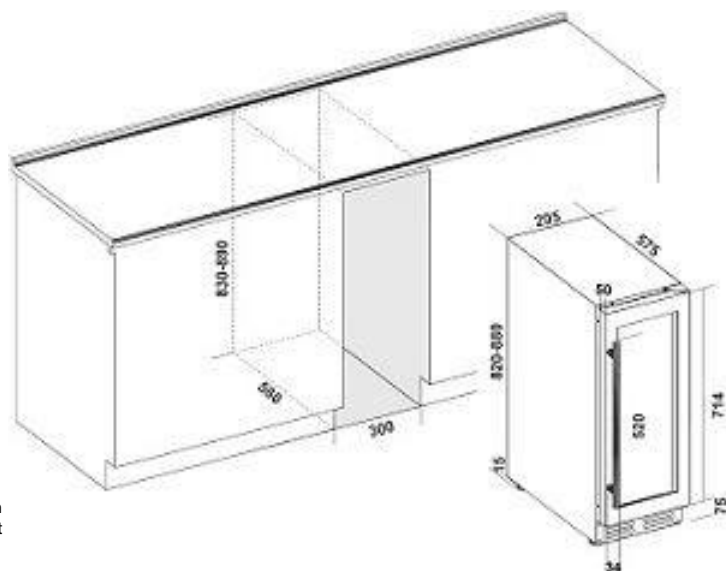

Eco-responsibility

Our products are manufactured in compliance with European environmental rules. Especially, refrigerant fluid (R600a) doesn't reject neither CFC nor HFC and respect environment.

Energy consumption is calculated based on the result obtained for 24h in standard test conditions. The actual energy consumption depends on the conditions of use and location of the device.

This equipment is designed to be used in an ambient temperature between 10-32°C.

This appliance is intended to be used exclusively for the storage of wine.

Alcohol abuse is dangerous for health, please consume in moderation.

*Capacity given as an indication with 75cl Bordeaux traditional type bottles and measured with 5 shelves. Adding shelves reduce considerably the total capacity.

Naziv: CBU18S2B

Eno-področna servirna vinska vitrina
Podpultno vgradna

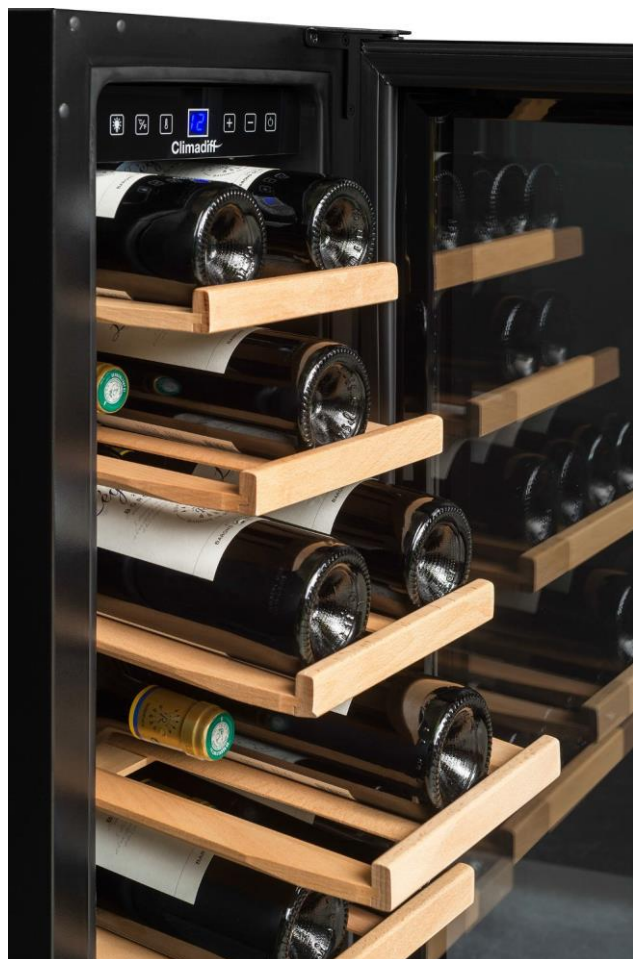

> VKLJUČENA OPREMA

- 5 fiksnih lesenih polic
- 1 fiksna lesena pol polica
- 4 nastavljive noge (v. 6 cm)
- Sistem proti vibracijam

> TEHNIČNE KARAKTERISTIKE

- Energijski razred:
F (po starem A)
- Letna poraba električne energije:
94 kWh
- Klimatski razred: SN-N (10°C - 32°C)
- Glasnost: 40 dB
- Napetost: 220-240 V
- Moč: 90 W
- Vrsta plina: R600a

> LOGISTIČNI PODATKI

Bruto dimenzije (šxGxV cm)	: 35,5 x 64,5 x 86,5
Neto dimenzije (šxGxV cm)	: 29,5 x 57,5 x 82
Bruto teža (kg)	: 32.00
Neto teža (kg)	: 30.00

EAN

3595320106374